

SHEET 5 SHEET 4 SHEET 3 SHEET LOCATION MAP NOT TO SCALE

MIRASOL PARCEL NINE

PART OF GOLF DIGEST P.C.D.
SECTIONS 32 AND 33, TOWNSHIP 41 SOUTH, RANGE 42 EAST AND
SECTIONS 4 AND 5, TOWNSHIP 42 SOUTH, RANGE 42 EAST,
CITY OF PALM BEACH GARDENS,
PALM BEACH COUNTY, FLORIDA
SHEET 1 OF 5

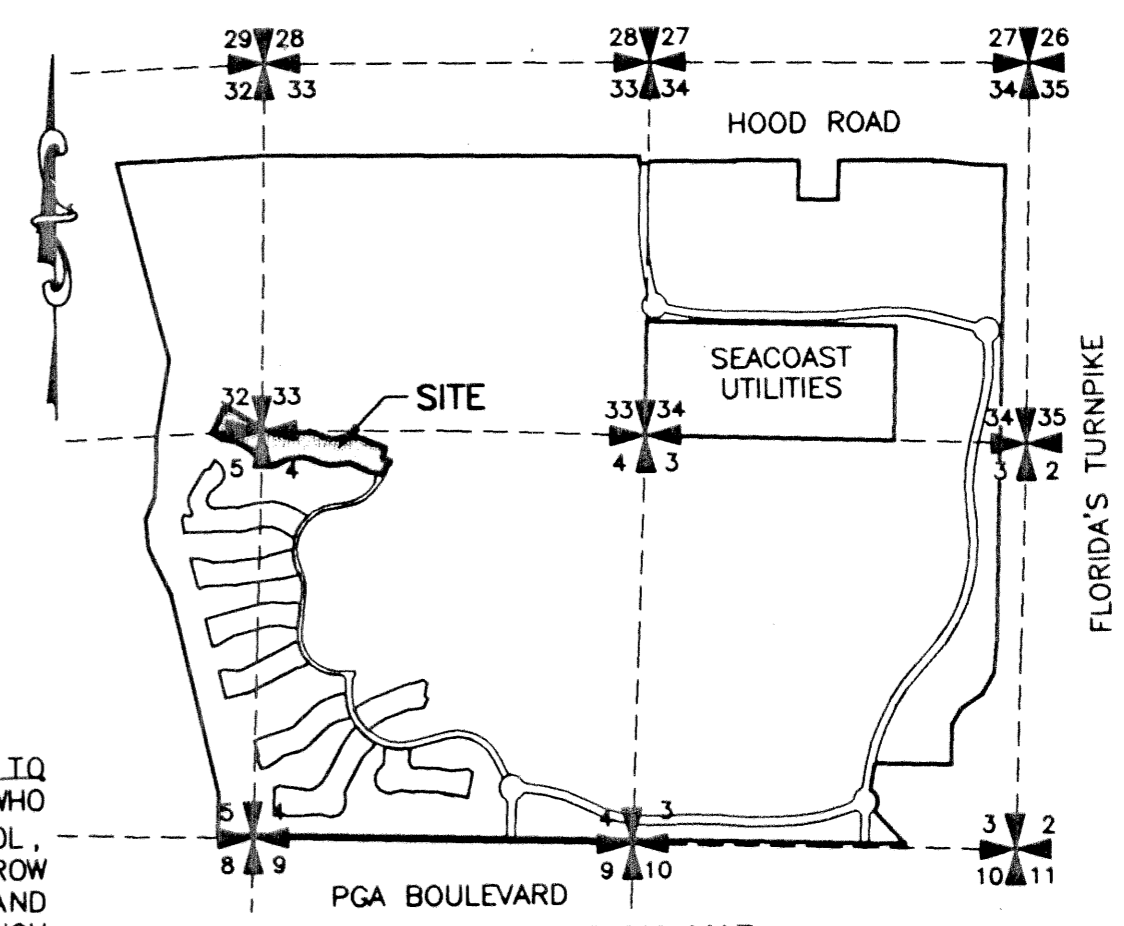

LOCATION MAP (NOT TO SCALE)

STATE OF FLORIDA
COUNTY OF PALM BEACH
THIS PLAT WAS FILED FOR
RECORD 10:45 A.M.
THIS 10th DAY OF May
AD, 2002 AND DULY RECORDED
IN PLAT BOOK 45 ON PAGES
5
DOROTHY H. WILKEN, CLERK
BY: *[Signature]*
CIRCUIT COURT SEAL

DEDICATION
KNOW ALL MEN BY THESE PRESENTS THAT TAYLOR WOODROW COMMUNITIES AT MIRASOL, LTD., A FLORIDA LIMITED PARTNERSHIP, LICENSED TO DO BUSINESS IN FLORIDA, OWNER OF THE LAND SHOWN HEREON, BEING IN SECTIONS 32 AND 33, TOWNSHIP 41 SOUTH, RANGE 42 EAST, CITY OF PALM BEACH GARDENS, PALM BEACH COUNTY, FLORIDA AND BEING PART OF GOLF DIGEST P.C.D., AND SHOWN HEREON AS "MIRASOL PARCEL NINE", BEING MORE PARTICULARLY DESCRIBED AS FOLLOWS:

A PARCEL OF LAND SITUATE IN SECTIONS 32 AND 33, TOWNSHIP 41 SOUTH, RANGE 42 EAST AND SECTIONS 4 AND 5, TOWNSHIP 42 SOUTH, RANGE 42 EAST, PALM BEACH COUNTY, FLORIDA, BEING MORE PARTICULARLY DESCRIBED AS FOLLOWS:

BEGINNING AT THE NORTHEAST CORNER OF MIRASOL WAY, TRACT A, MIRASOL PLAT TWO, ACCORDING TO THE PLAT THEREOF, AS RECORDED IN PLAT BOOK 89, PAGES 61 THROUGH 65, INCLUSIVE, OF THE PUBLIC RECORDS OF PALM BEACH COUNTY, FLORIDA; THENCE ALONG THE NORTH LINE OF SAID TRACT A, NORTH 69°39'04" WEST, A DISTANCE OF 60.00 FEET TO THE NORTHWEST CORNER OF SAID TRACT A; THENCE DEPARTING SAID TRACT A, NORTH 76°18'12" WEST, A DISTANCE OF 30.20 FEET; THENCE NORTH 83°35'35" WEST, A DISTANCE OF 85.56 FEET; THENCE NORTH 64°51'23" WEST, A DISTANCE OF 269.87 FEET TO THE POINT OF CURVATURE OF A CURVE CONCAVE TO THE SOUTH HAVING A RADIUS OF 78.00 FEET; THENCE NORTHWESTERLY ALONG THE ARC OF SAID CURVE THROUGH A CENTRAL ANGLE OF 34°54'04", AN ARC DISTANCE OF 47.51 FEET TO THE POINT OF TANGENCY; THENCE SOUTH 80°14'33" WEST, A DISTANCE OF 124.03 FEET TO THE POINT OF CURVATURE OF A CURVE CONCAVE TO THE NORTH HAVING A RADIUS OF 465.00 FEET; THENCE WESTERLY ALONG THE ARC OF SAID CURVE THROUGH A CENTRAL ANGLE OF 31°51'14", AN ARC DISTANCE OF 258.52 FEET TO THE POINT OF TANGENCY; THENCE NORTH 67°54'13" WEST, A DISTANCE OF 150.45 FEET TO THE POINT OF CURVATURE OF A CURVE CONCAVE TO THE SOUTH HAVING A RADIUS OF 200.00 FEET; THENCE WESTERLY ALONG THE ARC OF SAID CURVE THROUGH A CENTRAL ANGLE OF 28°06'24", AN ARC DISTANCE OF 98.11 FEET TO THE POINT OF TANGENCY; THENCE SOUTH 83°59'22" WEST, A DISTANCE OF 192.19 FEET TO THE POINT OF CURVATURE OF A CURVE CONCAVE TO THE SOUTHWEST HAVING A RADIUS OF 200.00 FEET; THENCE WESTERLY ALONG THE ARC OF SAID CURVE THROUGH A CENTRAL ANGLE OF 33°01'38", AN ARC DISTANCE OF 115.29 FEET TO THE POINT OF REVERSE CURVATURE OF A CURVE CONCAVE TO THE NORTH HAVING A RADIUS OF 198.00 FEET; THENCE SOUTHWESTERLY ALONG THE ARC OF SAID CURVE THROUGH A CENTRAL ANGLE OF 103°41'34", AN ARC DISTANCE OF 358.34 FEET TO THE POINT OF REVERSE CURVATURE OF A CURVE CONCAVE TO THE SOUTHWEST HAVING A RADIUS OF 200.00 FEET; THENCE NORTHWESTERLY ALONG THE ARC OF SAID CURVE THROUGH A CENTRAL ANGLE OF 33°34'27", AN ARC DISTANCE OF 117.20 FEET TO THE POINT OF TANGENCY; THENCE NORTH 58°55'09" WEST, A DISTANCE OF 219.28 FEET TO THE POINT OF CURVATURE OF A CURVE CONCAVE TO THE SOUTH HAVING A RADIUS OF 200.00 FEET; THENCE NORTHWESTERLY ALONG THE ARC OF SAID CURVE THROUGH A CENTRAL ANGLE OF 33°28'13", AN ARC DISTANCE OF 116.83 FEET TO THE POINT OF REVERSE CURVATURE OF A CURVE CONCAVE TO THE NORTH HAVING A RADIUS OF 198.00 FEET; THENCE WESTERLY ALONG THE ARC OF SAID CURVE THROUGH A CENTRAL ANGLE OF 26°02'16", AN ARC DISTANCE OF 89.98 FEET; THENCE NORTH 57°10'45" WEST, A DISTANCE OF 77.46 FEET; THENCE NORTH 66°44'03" WEST, A DISTANCE OF 76.24 FEET; THENCE NORTH 26°20'32" EAST, A DISTANCE OF 403.73 FEET; THENCE SOUTH 58°55'09" EAST, A DISTANCE OF 610.54 FEET TO THE POINT OF CURVATURE OF A CURVE CONCAVE TO THE NORTH HAVING A RADIUS OF 435.00 FEET; THENCE SOUTHEASTERLY ALONG THE ARC OF SAID CURVE THROUGH A CENTRAL ANGLE OF 37°05'29", AN ARC DISTANCE OF 281.60 FEET TO THE POINT OF TANGENCY; THENCE NORTH 83°59'22" EAST, A DISTANCE OF 210.13 FEET TO THE POINT OF CURVATURE OF A CURVE CONCAVE TO THE SOUTH HAVING A RADIUS OF 465.00 FEET; THENCE EASTERLY ALONG THE ARC OF SAID CURVE THROUGH A CENTRAL ANGLE OF 14°40'27", AN ARC DISTANCE OF 119.09 FEET; THENCE NORTH 08°39'50" EAST, A DISTANCE OF 16.42 FEET TO A POINT ON THE ARC OF A NON-TANGENT CURVE CONCAVE TO THE NORTHEAST HAVING A RADIUS OF 50.00 FEET FROM WHICH A RADIAL LINE BEARS NORTH 39°26'04" EAST; THENCE SOUTHEASTERLY ALONG THE ARC OF SAID CURVE THROUGH A CENTRAL ANGLE OF 27°58'40", AN ARC DISTANCE OF 24.42 FEET TO THE POINT OF REVERSE CURVATURE OF A CURVE CONCAVE TO THE SOUTH HAVING A RADIUS OF 475.00 FEET; THENCE EASTERLY ALONG THE ARC OF SAID CURVE THROUGH A CENTRAL ANGLE OF 10°38'23", AN ARC DISTANCE OF 88.21 FEET TO THE POINT OF TANGENCY; THENCE SOUTH 67°54'13" EAST, A DISTANCE OF 166.73 FEET TO THE POINT OF CURVATURE OF A CURVE CONCAVE TO THE NORTH HAVING A RADIUS OF 125.00 FEET; THENCE EASTERLY ALONG THE ARC OF SAID CURVE THROUGH A CENTRAL ANGLE OF 31°51'14", AN ARC DISTANCE OF 69.49 FEET TO THE POINT OF TANGENCY; THENCE NORTH 80°14'33" EAST, A DISTANCE OF 141.06 FEET TO THE POINT OF CURVATURE OF A CURVE CONCAVE TO THE SOUTH HAVING A RADIUS OF 475.00 FEET; THENCE EASTERLY ALONG THE ARC OF SAID CURVE THROUGH A CENTRAL ANGLE OF 30°06'23", AN ARC DISTANCE OF 249.59 FEET TO THE POINT OF TANGENCY; THENCE SOUTH 69°39'04" EAST, A DISTANCE OF 24.62 FEET; THENCE SOUTH 20°20'56" WEST, A DISTANCE OF 10.00 FEET; THENCE SOUTH 69°39'04" EAST, A DISTANCE OF 295.54 FEET; THENCE SOUTH 20°20'56" WEST, A DISTANCE OF 142.50 FEET; THENCE SOUTH 69°39'04" EAST, A DISTANCE OF 110.00 FEET; THENCE SOUTH 20°20'56" WEST, A DISTANCE OF 45.00 FEET; THENCE SOUTH 65°20'56" WEST, A DISTANCE OF 35.36 FEET; THENCE SOUTH 20°20'56" WEST, A DISTANCE OF 132.45 FEET TO THE POINT OF BEGINNING.

CONTAINING 837,573.808 SQUARE FEET OR 19.228 ACRES, MORE OR LESS.
HAVE CAUSED THE SAME TO BE SURVEYED AND PLATTED AS SHOWN HEREON AND DO HEREBY DEDICATE AS FOLLOWS:

1. TRACT A, AS SHOWN HEREON, IS HEREBY DEDICATED TO PALACIO AT MIRASOL PROPERTY OWNERS ASSOCIATION, INC., A FLORIDA CORPORATION, NOT FOR PROFIT, ITS SUCCESSORS AND ASSIGNS, FOR PRIVATE STREET, DRAINAGE, UTILITY AND OTHER PURPOSES NOT INCONSISTENT WITH THIS DEDICATION AND IS THE PERPETUAL MAINTENANCE OBLIGATION OF SAID ASSOCIATION, ITS SUCCESSORS AND ASSIGNS, WITHOUT RECOURSE TO THE CITY OF PALM BEACH GARDENS AND WITHOUT RECOURSE TO NORTHERN PALM BEACH COUNTY IMPROVEMENT DISTRICT.
2. TRACT B, AS SHOWN HEREON, IS HEREBY DEDICATED TO THE PALACIO AT MIRASOL PROPERTY OWNERS ASSOCIATION, INC., A FLORIDA CORPORATION, NOT FOR PROFIT, ITS SUCCESSORS AND ASSIGNS, FOR PRIVATE STREET, DRAINAGE, UTILITY AND OTHER PURPOSES NOT INCONSISTENT WITH THIS DEDICATION AND IS THE PERPETUAL MAINTENANCE OBLIGATION OF SAID ASSOCIATION, ITS SUCCESSORS AND ASSIGNS, WITHOUT RECOURSE TO THE CITY OF PALM BEACH GARDENS AND WITHOUT RECOURSE TO THE NORTHERN PALM BEACH COUNTY IMPROVEMENT DISTRICT.

3. TRACT C, AS SHOWN HEREON, IS HEREBY DEDICATED TO PALACIO AT MIRASOL PROPERTY OWNERS ASSOCIATION, INC., A FLORIDA CORPORATION, NOT FOR PROFIT, ITS SUCCESSORS AND ASSIGNS, FOR OPEN SPACE, LANDSCAPING AND SIGNAGE PURPOSES AND IS THE PERPETUAL MAINTENANCE OBLIGATION OF SAID ASSOCIATION, ITS SUCCESSORS AND ASSIGNS, WITHOUT RECOURSE TO THE CITY OF PALM BEACH GARDENS.

4. TRACT D, AS SHOWN HEREON, IS HEREBY DEDICATED, IN FEE SIMPLE, TO THE NORTHERN PALM BEACH COUNTY IMPROVEMENT DISTRICT (NPBCID), FOR THE CONSTRUCTION, OPERATION, INSPECTION AND MAINTENANCE FOR WATER MANAGEMENT FACILITIES, WITHOUT RECOURSE TO THE CITY OF PALM BEACH GARDENS.

5. THE UTILITY EASEMENTS (UE), AS SHOWN HEREON, ARE HEREBY DEDICATED IN PERPETUITY FOR THE CONSTRUCTION AND MAINTENANCE OF PUBLIC UTILITY FACILITIES, INCLUDING CABLE TELEVISION SYSTEMS. THE INSTALLATION OF CABLE TELEVISION SYSTEMS SHALL NOT INTERFERE WITH THE CONSTRUCTION AND MAINTENANCE OF OTHER PUBLIC UTILITIES.

6. THE PEDESTRIAN ACCESS EASEMENTS (PAE), AS SHOWN HEREON, ARE HEREBY DEDICATED TO THE COUNTRY CLUB AT MIRASOL COMMUNITY ASSOCIATION, INC., A FLORIDA CORPORATION, NOT FOR PROFIT, ITS SUCCESSORS AND ASSIGNS, FOR PEDESTRIAN ACCESS PURPOSES AND ARE THE PERPETUAL MAINTENANCE OBLIGATION OF SAID ASSOCIATION, ITS SUCCESSORS AND ASSIGNS, WITHOUT RECOURSE TO THE CITY OF PALM BEACH GARDENS.

7. A NON-EXCLUSIVE EASEMENT FOR INGRESS AND EGRESS OVER TRACTS A AND B IS HEREBY DEDICATED TO SEACOAST UTILITY AUTHORITY, ITS SUCCESSORS AND ASSIGNS, FOR ACCESS PURPOSES ONLY, SAID LAND BEING THE PERPETUAL MAINTENANCE OBLIGATION OF PALACIO AT MIRASOL PROPERTY OWNERS ASSOCIATION, INC., A FLORIDA CORPORATION, NOT FOR PROFIT, ITS SUCCESSORS AND ASSIGNS, FOR ACCESS PURPOSES ONLY, SAID LAND BEING THE PERPETUAL MAINTENANCE OBLIGATION OF SAID ASSOCIATION, ITS SUCCESSORS AND ASSIGNS, WITHOUT RECOURSE TO THE CITY OF PALM BEACH GARDENS.

8. AN INGRESS-EGRESS EASEMENT (IEE) OVER ALL OF TRACTS A AND B, AS SHOWN HEREON, IS HEREBY DEDICATED IN PERPETUITY ON A NON-EXCLUSIVE BASIS TO THE NORTHERN PALM BEACH COUNTY IMPROVEMENT DISTRICT (NPBCID), INCLUDING ITS STAFF AND AUTHORIZED CONSULTANTS, CONTRACTORS AND AGENTS, FOR PEDESTRIAN, VEHICULAR AND EQUIPMENT INGRESS AND EGRESS TO AND FROM NPBCID WATER MANAGEMENT FACILITIES, LANDS AND EASEMENTS FOR WATER MANAGEMENT PURPOSES, WITHOUT RECOURSE TO NORTHERN PALM BEACH COUNTY IMPROVEMENT DISTRICT.

9. AN INGRESS-EGRESS EASEMENT (IEE) OVER ALL OF TRACTS A AND B, AS SHOWN HEREON, IS HEREBY DEDICATED IN PERPETUITY ON A NON-EXCLUSIVE BASIS TO MIRASOL MASTER MAINTENANCE ASSOCIATION, INC., A FLORIDA CORPORATION, NOT FOR PROFIT, ITS SUCCESSORS AND ASSIGNS, FOR PEDESTRIAN, VEHICULAR AND EQUIPMENT INGRESS AND EGRESS.

10. THE DRAINAGE EASEMENT (DE), AS SHOWN HEREON, IS HEREBY DEDICATED TO MIRASOL MASTER MAINTENANCE ASSOCIATION, INC., A FLORIDA CORPORATION, NOT FOR PROFIT, ITS SUCCESSORS AND ASSIGNS, IN PERPETUITY FOR DRAINAGE PURPOSES. THE MAINTENANCE OF ALL DRAINAGE FACILITIES LOCATED THEREIN SHALL BE THE PERPETUAL MAINTENANCE OBLIGATION OF SAID ASSOCIATION, INC., ITS SUCCESSORS AND ASSIGNS, WITHOUT RECOURSE TO THE CITY OF PALM BEACH GARDENS AND WITHOUT RECOURSE TO THE NORTHERN PALM BEACH COUNTY IMPROVEMENT DISTRICT.

11. THE NORTHERN PALM BEACH COUNTY IMPROVEMENT DISTRICT INGRESS-EGRESS EASEMENT (NPBCID IEE), AS SHOWN HEREON, IS HEREBY DEDICATED IN PERPETUITY ON A NON-EXCLUSIVE BASIS TO THE NORTHERN PALM BEACH COUNTY IMPROVEMENT DISTRICT (NPBCID), INCLUDING ITS STAFF AND AUTHORIZED CONSULTANTS, CONTRACTORS AND AGENTS, FOR PEDESTRIAN, VEHICULAR AND EQUIPMENT INGRESS AND EGRESS TO AND FROM NPBCID WATER MANAGEMENT FACILITIES, LANDS AND EASEMENTS FOR WATER MANAGEMENT PURPOSES, WITHOUT RECOURSE TO NORTHERN PALM BEACH COUNTY IMPROVEMENT DISTRICT.

IN WITNESS WHEREOF, TWC/MIRASOL, INC., A FLORIDA CORPORATION, AS GENERAL PARTNER OF TAYLOR WOODROW COMMUNITIES AT MIRASOL, LTD., A FLORIDA LIMITED PARTNERSHIP, HAS CAUSED THESE PRESENTS TO BE SIGNED BY ITS VICE PRESIDENT AND ITS CORPORATE SEAL TO BE AFFIXED HERETO BY AND WITH THE AUTHORITY OF ITS BOARD OF DIRECTORS, THIS 10th DAY OF April, 2002.

TAYLOR WOODROW COMMUNITIES AT MIRASOL, LTD.,
A FLORIDA LIMITED PARTNERSHIP, f/k/a TWC/GOLF DIGEST, LTD.
BY: TWC/MIRASOL, INC., A FLORIDA CORPORATION,
f/k/a JCB GOLF VENTURES, INC.,
AS GENERAL PARTNER OF TAYLOR WOODROW COMMUNITIES AT
MIRASOL, LTD.

WITNESS: *[Signature]* BY: *[Signature]*
PRINT NAME: *Emily Herschaft* CRAIG A. PERNA
VICE PRESIDENT
WITNESS: *[Signature]*
PRINT NAME: *Edwin J. Hill*

SEAL TWC/MIRASOL, INC. SEAL MIRASOL MASTER MAINTENANCE ASSOCIATION, INC. SEAL CITY OF PALM BEACH GARDENS SEAL REVIEWING SURVEYOR AND MAPPER

ACKNOWLEDGEMENT

STATE OF FLORIDA)
COUNTY OF PALM BEACH)
BEFORE ME PERSONALLY APPEARED CRAIG A. PERNA WHO IS PERSONALLY KNOWN TO ME, OR HAS PRODUCED *[Signature]* AS IDENTIFICATION, AND WHO EXECUTED THE FOREGOING INSTRUMENT AS THE VICE PRESIDENT OF TWC/MIRASOL, INC., A FLORIDA CORPORATION, AS GENERAL PARTNER OF TAYLOR WOODROW COMMUNITIES AT MIRASOL, LTD., A FLORIDA LIMITED PARTNERSHIP, AND SEVERALLY ACKNOWLEDGED TO AND BEFORE ME THAT HE EXECUTED SUCH INSTRUMENT AS SUCH OFFICER OF SAID CORPORATION, AND THAT THE SEAL AFFIXED TO THE FOREGOING INSTRUMENT IS THE CORPORATE SEAL OF SAID CORPORATION AND THAT IT WAS AFFIXED TO SAID INSTRUMENT BY DUE AND REGULAR CORPORATE AUTHORITY.

WITNESS MY HAND AND OFFICIAL SEAL THIS 10th DAY OF April, 2002.
MY COMMISSION EXPIRES: 10/8/2004 DATE *[Signature]* NOTARY PUBLIC

EMILY HERSCHAFT
No. CC 973906
[Signature]
SEAL NOTARY PUBLIC

ACCEPTANCE OF RESERVATIONS

STATE OF FLORIDA)
COUNTY OF PALM BEACH)
MIRASOL MASTER MAINTENANCE ASSOCIATION, INC., A FLORIDA CORPORATION, NOT FOR PROFIT, HEREBY ACCEPTS THE DEDICATIONS OR RESERVATIONS TO SAID ASSOCIATION AS STATED AND SHOWN HEREON, AND HEREBY ACCEPTS ITS MAINTENANCE OBLIGATIONS FOR SAME AS STATED HEREON, DATED THIS 10th DAY OF April, 2002.

MIRASOL MASTER MAINTENANCE ASSOCIATION, INC.,
A FLORIDA CORPORATION, NOT FOR PROFIT
WITNESS: *[Signature]* BY: *[Signature]*
PRINT NAME: *Emily Herschaft* CRAIG A. PERNA
VICE PRESIDENT
WITNESS: *[Signature]*
PRINT NAME: *Edwin J. Hill*

ACKNOWLEDGEMENT

STATE OF FLORIDA)
COUNTY OF PALM BEACH)
BEFORE ME PERSONALLY APPEARED CRAIG A. PERNA WHO IS PERSONALLY KNOWN TO ME, OR HAS PRODUCED *[Signature]* AS IDENTIFICATION, AND WHO EXECUTED THE FOREGOING INSTRUMENT AS PRESIDENT OF MIRASOL MASTER MAINTENANCE ASSOCIATION, INC., A FLORIDA CORPORATION, NOT FOR PROFIT, AND SEVERALLY ACKNOWLEDGED TO AND BEFORE ME THAT HE EXECUTED SUCH INSTRUMENT AS SUCH OFFICER OF SAID CORPORATION, AND THAT THE SEAL AFFIXED TO THE FOREGOING INSTRUMENT IS THE CORPORATE SEAL OF SAID CORPORATION AND THAT IT WAS AFFIXED TO SAID INSTRUMENT BY DUE AND REGULAR CORPORATE AUTHORITY.

WITNESS MY HAND AND OFFICIAL SEAL THIS 10th DAY OF April, 2002.
MY COMMISSION EXPIRES: 10/8/2004 DATE *[Signature]* NOTARY PUBLIC

EMILY HERSCHAFT
No. CC 973906
[Signature]
SEAL NOTARY PUBLIC

APPROVALS

CITY OF PALM BEACH GARDENS
COUNTY OF PALM BEACH, FLORIDA
THIS PLAT IS HEREBY APPROVED FOR RECORD DATED THIS 10th DAY OF May, 2002.
ATTEST: *[Signature]* BY: *[Signature]*
CAROL GOLB, CITY CLERK JOSEPH R. RUSSO, MAYOR
RENEE KAVYNDY *[Signature]*
CITY ENGINEER: *[Signature]*
THIS PLAT IS HEREBY ACCEPTED FOR RECORD DATED THIS 10th DAY OF May, 2002.
BY: *[Signature]*
LENNART E. LINDAHL, P.E., CITY ENGINEER

REVIEWING SURVEYOR

STATE OF FLORIDA)
COUNTY OF PALM BEACH)
THIS PLAT HAS BEEN REVIEWED FOR CONFORMITY IN ACCORDANCE WITH CHAPTER 177.08(1) OF THE FLORIDA STATUTES AND THE ORDINANCES OF THE CITY OF PALM BEACH GARDENS. THIS REVIEW DOES NOT INCLUDE THE VERIFICATION OF THE GEOMETRIC DATA, PERMANENT CONTROL POINTS (PCP'S) OR MONUMENTS AT LOT CORNERS.
BY: *[Signature]* DATE: 30 April 02
PASQUALE VOLPE
PROFESSIONAL SURVEYOR AND MAPPER LICENSE NO. 4873

NORTHERN PALM BEACH COUNTY IMPROVEMENT DISTRICT LAND USE CLASSIFICATION	CODE
SINGLE FAMILY(OTHER)	SFO
EXEMPT ACREAGE	EXM

P.C.D. TABULAR DATA

LOT	ACRES	LAND USE CODE
LOT 1	0.393	ACRES SFO
LOT 2	0.393	ACRES SFO
LOT 3	0.408	ACRES SFO
LOT 4	0.480	ACRES SFO
LOT 5	0.421	ACRES SFO
LOT 6	0.466	ACRES SFO
LOT 7	0.433	ACRES SFO
LOT 8	0.421	ACRES SFO
LOT 9	0.459	ACRES SFO
LOT 10	0.393	ACRES SFO
LOT 11	0.397	ACRES SFO
LOT 12	0.435	ACRES SFO
LOT 13	0.435	ACRES SFO
LOT 14	0.408	ACRES SFO
LOT 15	0.393	ACRES SFO
LOT 16	0.393	ACRES SFO
LOT 17	0.425	ACRES SFO
LOT 18	0.589	ACRES SFO
LOT 19	0.625	ACRES SFO
LOT 20	0.530	ACRES SFO
LOT 21	0.394	ACRES SFO
LOT 22	0.393	ACRES SFO
LOT 23	0.432	ACRES SFO
LOT 24	0.512	ACRES SFO
LOT 25	0.547	ACRES SFO
LOT 26	0.485	ACRES SFO
LOT 27	0.400	ACRES SFO
LOT 28	0.411	ACRES SFO
LOT 29	0.452	ACRES SFO
LOT 30	0.396	ACRES SFO
LOT 31	0.442	ACRES SFO
LOT 32	0.423	ACRES SFO
LOT 33	0.465	ACRES SFO
LOT 34	0.471	ACRES SFO
LOT 35	0.478	ACRES SFO
LOT 36	0.479	ACRES SFO
TRACT A	2.572	ACRES EXM
TRACT B	0.345	ACRES EXM
TRACT C	0.103	ACRES EXM
TRACT D	0.131	ACRES EXM
TOTAL	19.228	ACRES

THIS INSTRUMENT WAS PREPARED BY MARY HANNA CLODFELTER, P.S.M. IN THE OFFICES OF MOCK, ROOS & ASSOCIATES, INC., 5720 CORPORATE WAY, WEST PALM BEACH, FLORIDA 33407.

SCALE: N/A
P.A. NO.: 99362.00
DATE: NOVEMBER, 2001
DRAWING NO.: 41-42-32-53
FLORIDA L.B. NO. 48
MOCK • ROOS
ENGINEERS • SURVEYORS • PLANNERS
5720 Corporate Way, West Palm Beach, Florida 33407
(561) 683-3113, fax 478-7248

MIRASOL PARCEL NINE
PART OF GOLF DIGEST P.C.D.
SITUATE IN SECTIONS 32 AND 33,
TOWNSHIP 41 SOUTH, RANGE 42 EAST,
AND IN SECTIONS 4 AND 5,
TOWNSHIP 42 SOUTH, RANGE 42 EAST,
CITY OF PALM BEACH GARDENS,
PALM BEACH COUNTY, FLORIDA